

# Closed End Rivets

Exclusive rivet design featuring a cup shaped end configuration ideal for applications that need to be water tight or when stem retention is paramount.



## Key features and benefits

- Seals out moisture, air and other contaminants
- Higher tensile and shear strength than the equivalent open end rivet
- 100% stem retention



Blindside set view

## Specifications

Sizes:

1/8" – 1/4"

(3.2 mm – 6.4 mm)

Materials:

Aluminum, Steel,  
Stainless Steel

Head Styles:

Dome, Countersunk

## Typical placing sequence

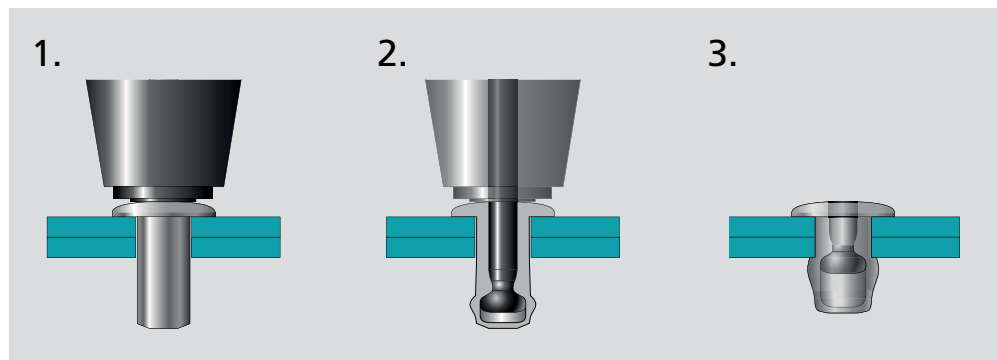

Please visit our website for fastener placing animations and technical data.

## Assembly applications

- White goods
- Electronic enclosure
- Signs
- Outdoor cases
- Scoreboards
- LED signs
- Recreational vehicles

White goods



Lawn and garden



School bus



Electronic enclosure



Electronic switch



Sunroof







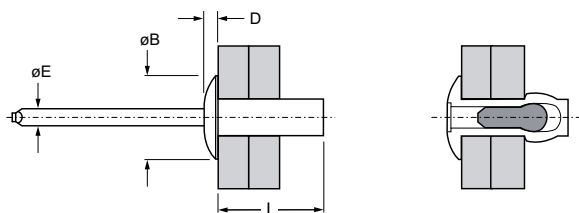

| English                    | Français                  | Deutsch                          | Italiano                              | Español                      |
|----------------------------|---------------------------|----------------------------------|---------------------------------------|------------------------------|
| Dome head                  | Tête plate                | Flachrundkopf                    | Testa Tonda                           | Cabeza alomada               |
| Body: Aluminum*<br>Natural | Corps: Aluminium*<br>Brut | Hülse: Aluminium*<br>Unbehandelt | Corpo: Alluminio*<br>Nessuna finitura | Cuerpo: Aluminio*<br>Natural |
| Body: Aluminum<br>Natural  | Corps: Aluminium<br>Brut  | Hülse: Aluminium<br>Unbehandelt  | Corpo: Alluminio<br>Nessuna finitura  | Cuerpo: Aluminio<br>Natural  |

\*: 1100

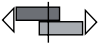

| Ø              |  |                |  |                | L              | ØE            | ØB             | D             |  |  | Part No. |
|----------------|--|----------------|--|----------------|----------------|---------------|----------------|---------------|---|---|----------|
| nom.           | min.   | max.           | min.   | max.           | ref.           | ref.          | max.           | max.          | lbf (kN) <sup>1)</sup>  | lbf (kN) <sup>1)</sup>  |          |
| 1/8"<br>(3.2)  | .032<br>(0.8)  | .062<br>(1.6)  | .129<br>(3.28)   | .133<br>(3.38) | .237<br>(6.0)  | .072<br>(1.8) | .248<br>(6.3)  | .051<br>(1.3) | 105<br>(0.47)   | 150<br>(0.67)   | AD 41 AH |
|                | .063<br>(1.6)  | .125<br>(3.2)  |  |                | .301<br>(7.7)  |               |                |               |   |   | AD 42 AH |
|                | .126<br>(3.2)  | .187<br>(4.8)  |  |                | .362<br>(9.2)  |               |                |               |   |   | AD 43 AH |
|                | .188<br>(4.8)  | .250<br>(6.4)  |  |                | .425<br>(10.8) |               |                |               |   |   | AD 44 AH |
| 5/32"<br>(4.0) | .126<br>(3.2)  | .187<br>(4.8)  | .160<br>(4.06)   | .164<br>(4.17) | .377<br>(9.6)  | .090<br>(2.3) | .327<br>(8.4)  | .066<br>(1.7) | 155<br>(0.69)   | 240<br>(1.07)   | AD 53 AH |
|                | .188<br>(4.8)  | .250<br>(6.4)  |  |                | .440<br>(11.2) |               |                |               |   |   | AD 54 AH |
|                | .251<br>(6.4)  | .312<br>(7.9)  |  |                | .502<br>(12.8) |               |                |               |   |   | AD 55 AH |
| 3/16"<br>(4.8) | .063<br>(1.6)  | .125<br>(3.2)  | .192<br>(4.88)   | .196<br>(4.98) | .330<br>(8.4)  | .108<br>(2.7) | .393<br>(10.0) | .081<br>(2.1) | 220<br>(0.98)   | 310<br>(1.38)   | AD 62 AH |
|                | .126<br>(3.2)  | .250<br>(6.4)  |  |                | .455<br>(11.6) |               |                |               |   |   | AD 64 AH |
|                | .251<br>(6.4)  | .375<br>(9.5)  |  |                | .580<br>(14.7) |               |                |               |   |   | AD 66 AH |
|                | .376<br>(9.5)  | .500<br>(12.7) |  |                | .705<br>(17.9) |               |                |               |   |   | AD 68 AH |

dimensions in inches and (mm) / en pouces et (millimètre) / alle Maße in Zoll und (mm) / in pollici e (millimetri) / en pulgadas y (milímetros)

1) typical values / valeurs moyennes / typische Werte / Valori tipici / valores típicos